

ISSUES

1. Relationship of Infill / Urban Buildings to Street

More Industrial type business that would have significantly less foot traffic / benefit from additional street parking from the city

2. Width & Use of Sidewalks and Proximity to Traffic and Parking

3. Location of Transit / Streetcar, Buses, Bikes, and Travel Lanes

Add the Pearl to Via #7 route that already hits area sites

Keep bikes diverted to Ave B bc putting any on Broadway here would overflow to the more retail / heavier traffic areas of N Broadway

4. Type & Location of Parking

Parking to be built under 281

5. Placement of Landscape Trees, Buffers

Like sidewalk trees to soften view of the area

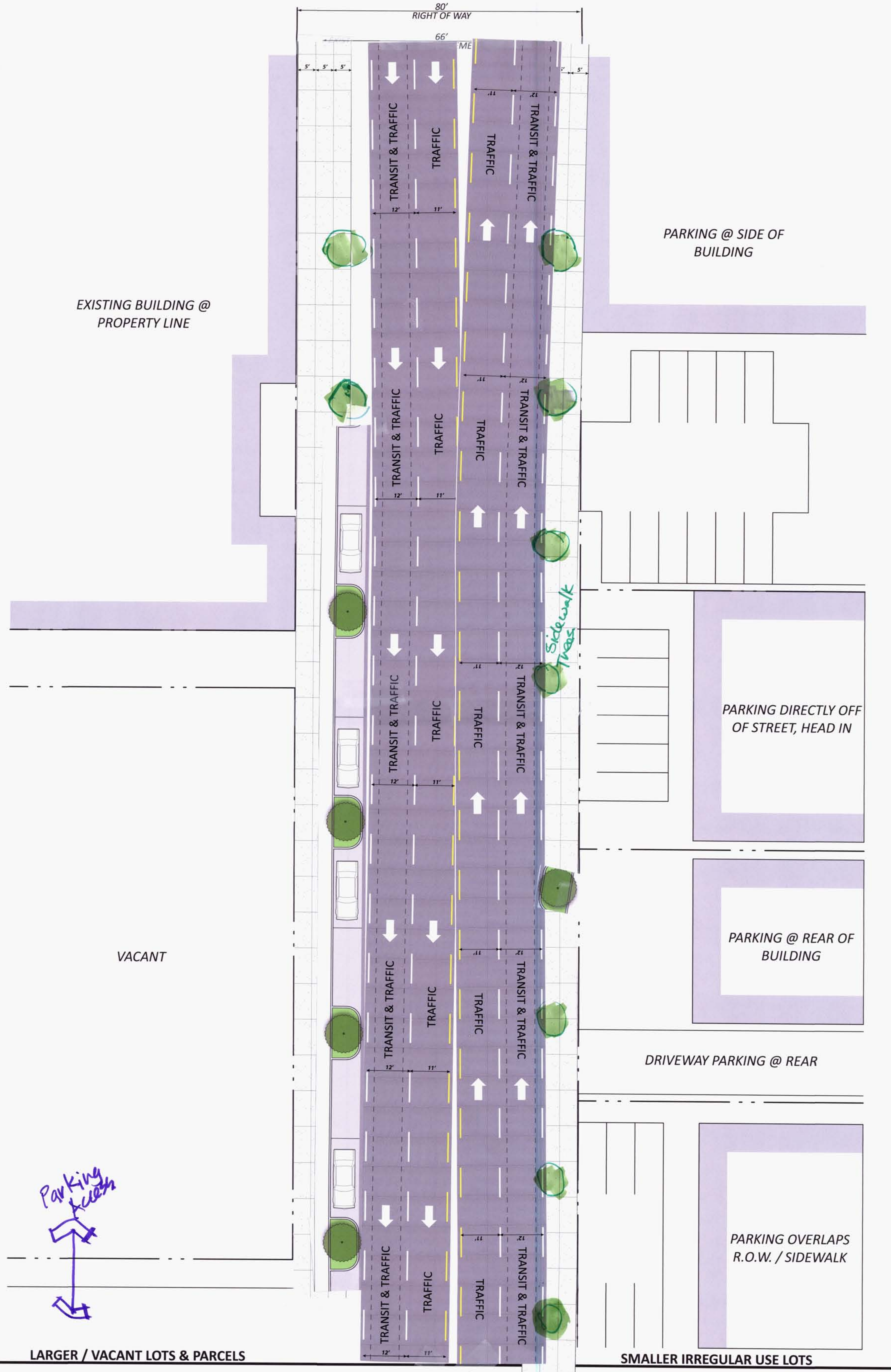

COMMENTS:

TABLE 1

