

ISSUES

1. Relationship of Infill / Urban Buildings to Street

- CONSIDER ACCESS TO BLDGS. AND HOW THAT CAN AFFECT INDIVIDUAL BUSINESSES.

2. Width & Use of Sidewalks and Proximity to Traffic and Parking

- UPPER BROADWAY. 6'-8'
- BRIDGE OR GATEWAY AREA.

3. Location of Transit / Streetcar, Buses, Bikes, and Travel Lanes

- COMMUTERS (BIKERS)
- THROUGH OUT

4. Type & Location of Parking

- NEED FOR TURN LANES? PRIORITIZE MAY NOT NEED AT EVERY LOCATION.
- ENCOURAGE MORE COMMON ACCESS DRIVEWAYS
- CLOSE OFF ADJACENT PARKING AREAS
- CONSOLIDATE DRIVEWAYS.
- PARKING SERVES BUSINESSES.

5. Placement of Landscape Trees, Buffers

BURY UTILITIES

SECTION DOESN'T HAVE TO BE THE SAME ON BOTH SIDES OF THE STREET

- PUBLIC ART mosaic art along sidewalks sculpture
- CONSIDER "GATEWAY" ELEMENT

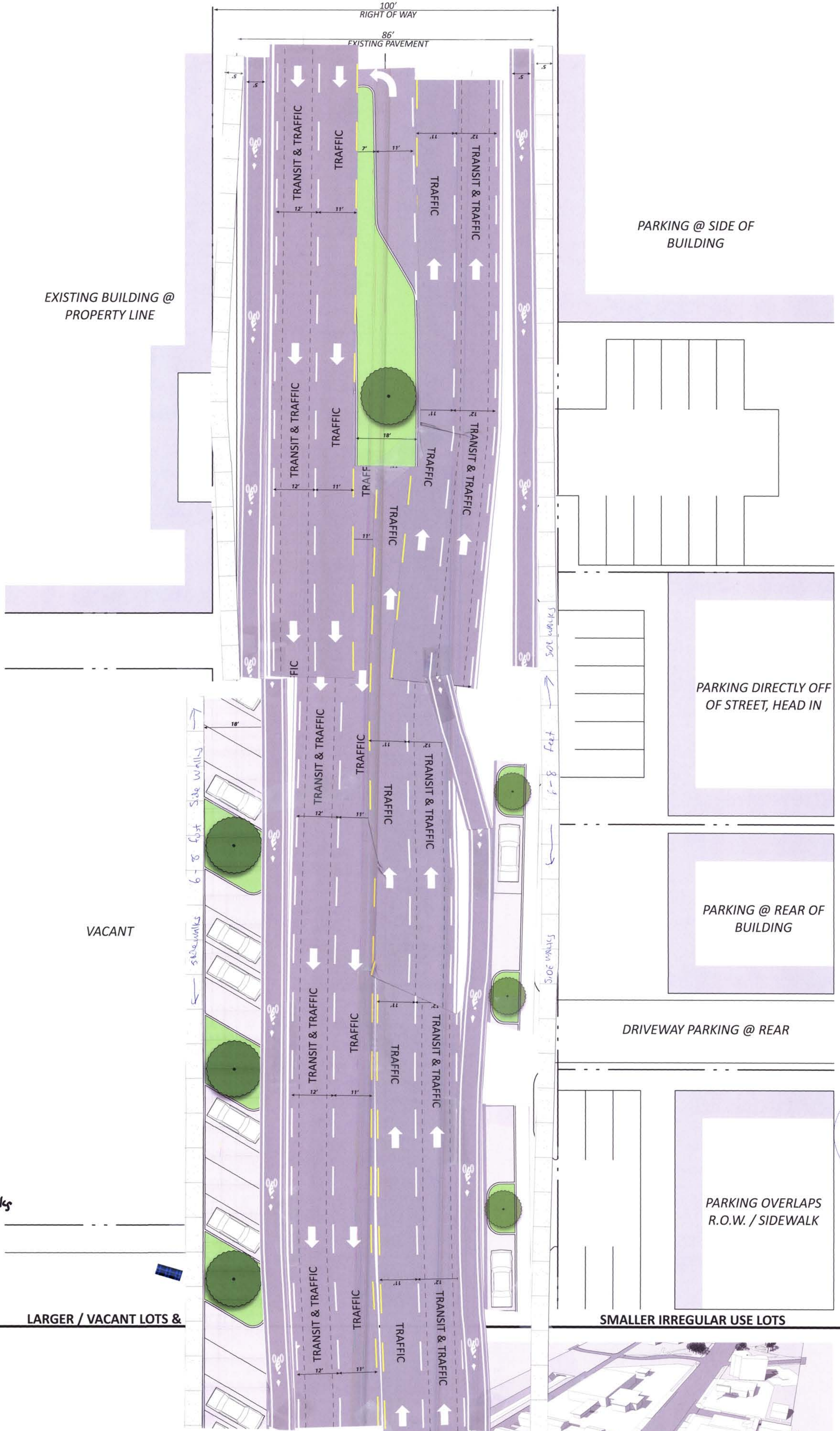

COMMENTS:

2

UPPER BROADWAY - 100' R.O.W.